

INERT GAS

EQUIPMENT

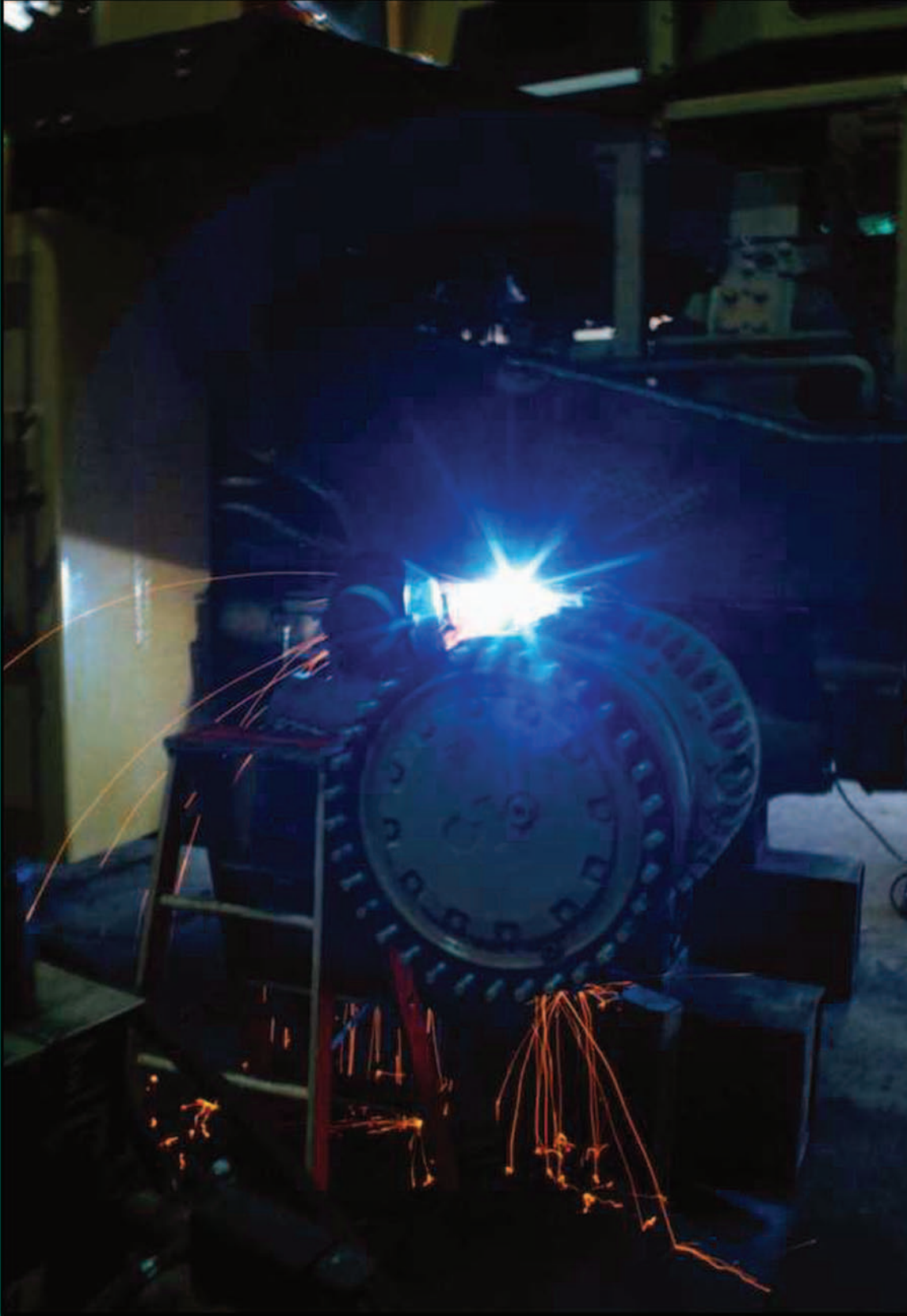



The Symbol of the Independent Welding Distributor

TIG TORCHES

WATER RUGGED PERFORMERS COOLED HIGH AMPERAGE CAPACITY

18 Series • Water cooled

Description: Heavy duty production duty torch for DC and AC applications. Pencil model available. Gas lens accessories available.

Part model	Cable assy.	Max Amps	
18-12*	12.5 ft	350	(M) Machine model
18-25*	25 ft	350	(P) Pencil models also available
18-12R*	12.5 ft	350	* (R) Available with rubber cables
18-25R*	25 ft	350	(V) Some available with gas valves.
18SP-12*	12.5 ft	350	
18SP-25*	25 ft	350	
18SPM-12*	12.5 ft	350	
18SPM-25*	25 ft	350	
18V-12*	12.5 ft	350	
18V-25*	25 ft	350	



Standard Model

20 Series • Water cooled

Description: Compact general duty torch for DC and AC applications. 20H model has 300 amp rating. Pencil model available. Gas lens accessories available.

Part model	Cable assy.	Max Amps	
20-12*#	12.5 ft	250	#(F) Flex Head models also available
20-25*#	25 ft	250	(H) Heavy duty
20H-12*	12.5 ft	300	(P) Pencil models also available
20H-25*	25 ft	300	* (R) Available with rubber cables
20P-12*	12.5 ft	225	(V) Some available with gas valves.
20P-25*	25 ft	225	
20V-12*	12.5 ft	250	
20V-25*	25 ft	250	



Flex-Head Model

24 Series • Water cooled

Description: Small compact head to reach tight weld areas. Gas lens accessories available.

Part model	Cable assy.	Max Amps	
24W-12*	12.5 ft	180	(F) Flex Head models also available
24W-25*	25 ft	180	* (R) Available with rubber cables
24WF-12*	12.5 ft	180	
24WF-25 *	25 ft	180	

25 Series • Water cooled

Description: Flexible neck which can be bent to any angle to access difficult welds. Gas lens accessories available.

Part model	Cable assy.	Max Amps	
25-12*	12.5 ft	225	* (R) Available with rubber cables
25-25*	25 ft	225	



The Symbol of the Independent Welding Distributor

TIG TORCH ASSEMBLY

18 18SP 18V Parts Breakdown

350 AMPS • WATER COOLED

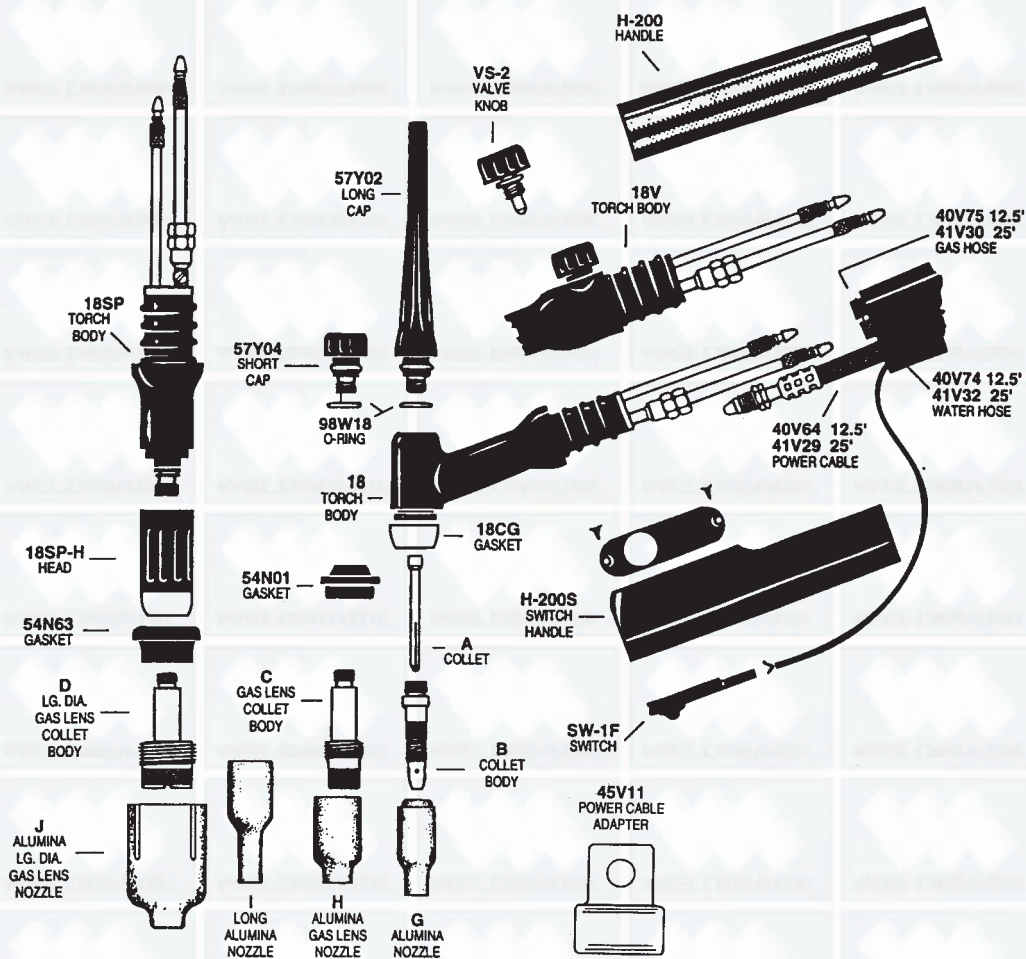

Collets • Collet Bodies • Gas Lens

Item	Electrode Diameter	.020 0, 5	.040 1, 0	1/16 1, 6	3/32 2, 4	1/8 3, 2	5/32 4, 0
A	Collet	10N21	10N22	10N23	10N24	10N25	54N20
B	Collet Body	10N29	10N30	10N31	10N32	10N28	406488
C	Gas Lens	45V29	45V24	45V25	45V26	45V27	45V28
D	Lg. Dia. Gas Lens	45V0204		45V116	45V64	995795	45V63

Gas Nozzles

Item	Size	4 1/4"	5 5/16"	6 3/8"	7 7/16"	8 1/2"	10 5/8"	12 3/4"	Short
G	Alumina	10N50	10N49	10N48	10N47	10N46	10N45	10N44	--
H	Alumina Gas Lens	54N18	54N17	54N16	54N15	54N14	--	--	54N19
I	Long Alumina	--	10N49L	10N48L	10N47L	--	--	--	--
J	Alumina Lg. Dia. Gas Lens	--	--	57N75	--	57N74	53N88	53N87	53N89

Accessory Kit AK-3 18, 18V

Contains: Short cap, 3 Collets, 3 Collet Bodies, 3 Nozzles, 3 Tungsten Electrodes.



The Symbol of the Independent Welding Distributor

TIG TORCH ASSEMBLY

20 (250 amps) 20F (225 amps) 20H (300 amps)
20P (225 amps) 25 (225 amps) Parts Breakdown

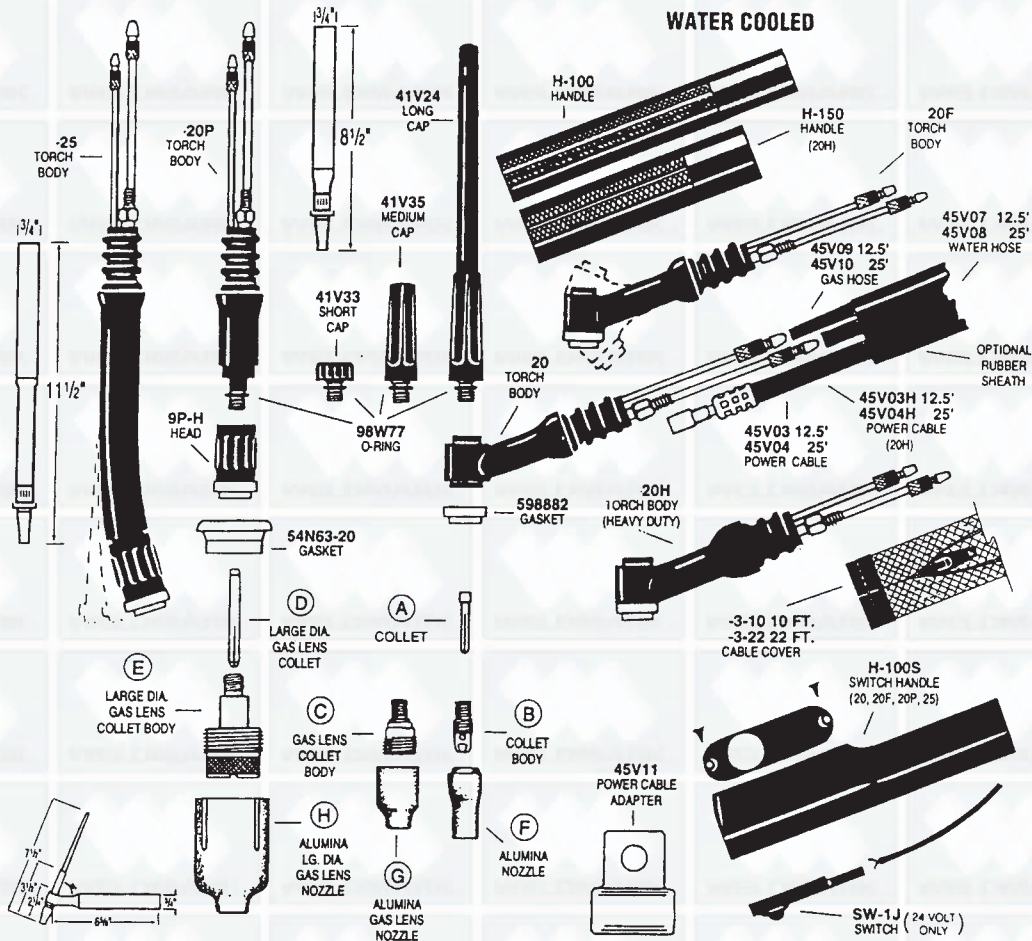

Collets • Collet Bodies • Gas Lens

Item	Electrode Diameter	.020 0, 5	.040 1, 0	1/16 1, 6	3/32 2, 4	1/8 3, 2
A	Collet	13N20	13N21	13N22	13N23	13N24
B	Collet Body	13N25	13N26	13N27	13N28	13N29
C	Gas Lens	45V41	45V42	45V43	45V44	45V45
D	Lg. Dia. Gas Lens Collet	13N20L	13N21L	13N22L	13N23L	13N24L
E	Lg. Dia. Gas Lens	45V0204S	45V116S	45V64S	995795S	

Gas Nozzles

Item	Size	4 1/4"	5 5/16"	6 3/8"	7 7/16"	8 1/2"	10 5/8"	12 3/4"
F	Alumina	13N08	13N09	13N10	13N11	13N12	13N13	--
G	Alumina Gas Lens	53N58	53N59	53N60	53N61	53N61S	--	--
H	Alumina Lg. Dia. Gas Lens	--	--	57N75	--	57N74	53N88	53N87

Accessory Kit AK-4 20, 20H, 20F

Contains: Long cap, 3 Collets, 3 Collet Bodies, 3 Nozzles, 3 Tungsten Electrodes.

Accessory Kit AK-4A 20P, 25

Contains: AK-4 less long cap.



The Symbol of the Independent Welding Distributor

TIG TORCH ASSEMBLY

20 (250 amps) 20F (225 amps) 20H (300 amps)
20P (225 amps) 25 (225 amps) Parts Breakdown

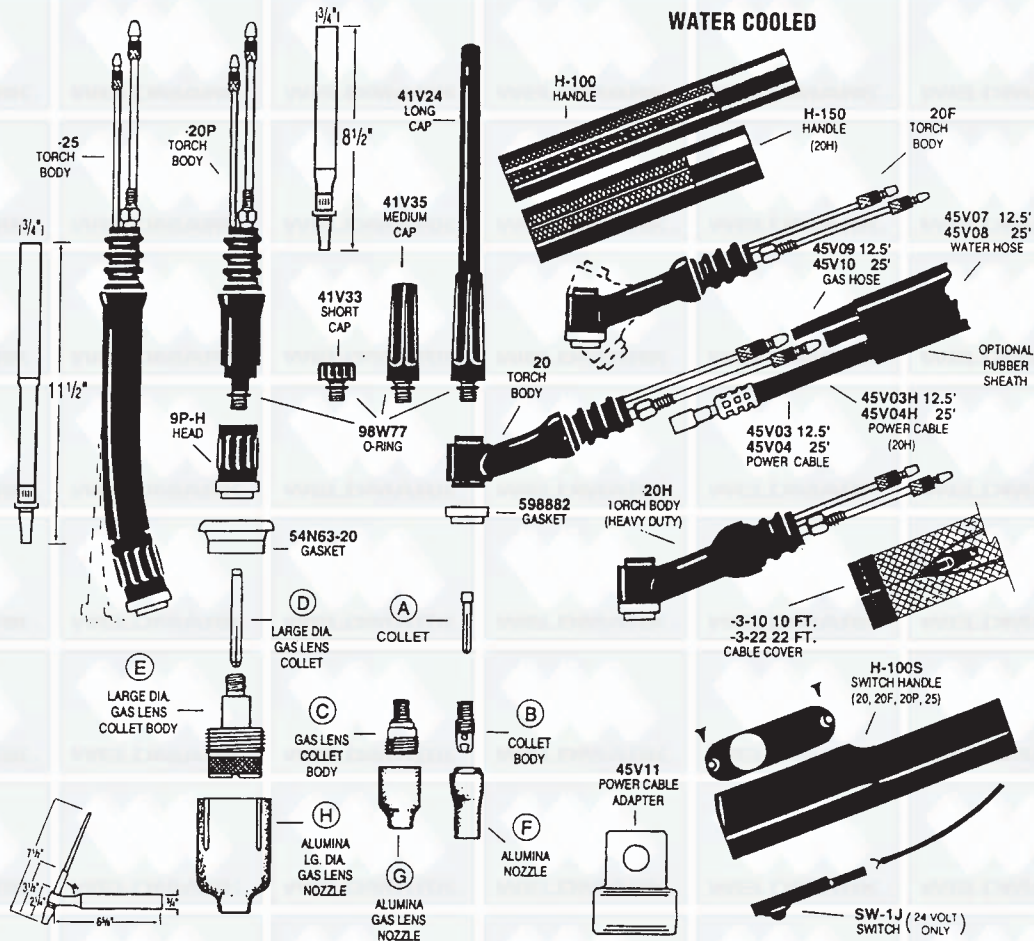

Collets • Collet Bodies • Gas Lens

Item	Electrode Diameter	.020 0, 5	.040 1, 0	1/16 1, 6	3/32 2, 4	1/8 3, 2
A	Collet	13N20	13N21	13N22	13N23	13N24
B	Collet Body	13N25	13N26	13N27	13N28	13N29
C	Gas Lens	45V41	45V42	45V43	45V44	45V45
D	Lg. Dia. Gas Lens Collet	13N20L	13N21L	13N22L	13N23L	13N24L
E	Lg. Dia. Gas Lens	45V0204S	45V116S	45V64S	995795S	

Gas Nozzles

Item	Size	4 1/4"	5 5/16"	6 3/8"	7 7/16"	8 1/2"	10 5/8"	12 3/4"
F	Alumina	13N08	13N09	13N10	13N11	13N12	13N13	--
G	Alumina Gas Lens	53N58	53N59	53N60	53N61	53N61S	--	--
H	Alumina Lg. Dia. Gas Lens	--	--	57N75	--	57N74	53N88	53N87

Accessory Kit AK-4 20, 20H, 20F

Contains: Long cap, 3 Collets, 3 Collet Bodies, 3 Nozzles, 3 Tungsten Electrodes.

Accessory Kit AK-4A 20P, 25

Contains: AK-4 less long cap.



The Symbol of the Independent Welding Distributor

TIG TORCH ASSEMBLY

24 24W 24V Parts Breakdown

80 AMPS • AIR COOLED
180 AMPS • WATER COOLED

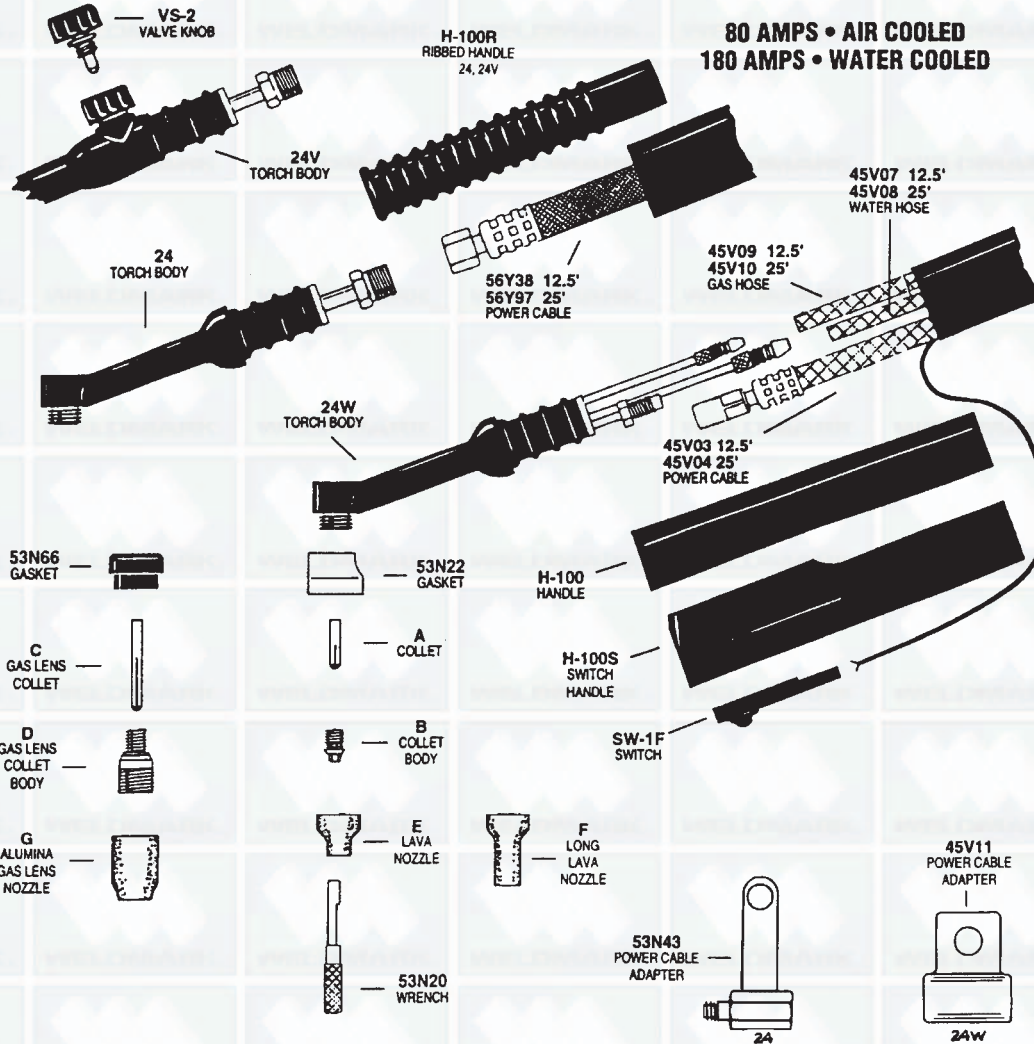

Collets • Collet Bodies • Gas Lens

Item	Electrode Diameter	.020 0, 5	.040 1, 0	1/16 1, 6	3/32 2, 4
A	Collet	53N15	53N16	53N14	24C332
B	Collet Body	53N17	53N18	53N19	24CB332
C	Gas Lens Collet	53N62	53N63	53N64	24GLC332
D	Gas Lens	45V41	45V42	45V43	45V44

Gas Nozzles

Item	Size	.165"	4 1/4"	5 5/16"	6 3/8"	7 7/16"
E	Alumina	53N23	53N24A	53N25A	53N27A	--
F	Long Lava	--	53N28	--	53N26	--
G	Alumina Gas Lens	--	53N58	53N59	53N60	53N61

Accessory Kit AK-5 24

Contains: No Back Cap, 3 Collets, 3 Collet Bodies, 3 Nozzles, 3 Tungsten Electrodes.

Accessory Kit AK-5W 24W

Contains: No Back Cap, 3 Collets, 3 Collet Bodies, 3 Nozzles, 3 Tungsten Electrodes.



The Symbol of the Independent Welding Distributor

TIG TORCHES

AIR QUALITY CONSTRUCTION COOLED

For Trouble-Free Performance

- High-Dielectric Silicone Rubber Insulation
- High Conductivity Copper Construction
- Quick Release Tungsten Adjustment
- Built-in Gas Control Valves on Many Models
- Wide Selection of Accessories

9 Series • Air cooled

Description: Light duty versatile torches. Pencil style and flex heads available. Optional gas valve. Rubber (R) or 2 pc. cables (-2).

Part model	Cable assy.	Max Amps	Part model	Cable assy.	Max Amps
9-12R	12.5 ft	125	9P-12R	12.5 ft	125
9-25R	25 ft	125	9P-25R	25 ft	125
9F-12R	12.5 ft	125	9V-12R	12.5 ft	125
9F-25R	25 ft	125	9V-25R	25 ft	125
9FV-12R	12.5 ft	125			
9FV-25R	25 ft	125			

(F) Flex Head models also available
(P) Pencil models also available
(R) Rubber power cable assembly
(V) Some available with gas valves.

Thin Gauge Materials • Field Welding Applications

17 Series • Air cooled

Description: Medium duty torches with optional gas valve and flex heads. Gas lens accessories available. Rubber (R) or 2 pc. cables (-2).

Part model	Cable assy.	Max Amps
17-12R	12.5 ft	150
17-25R	25 ft	150
17F-12R	12.5 ft	150
17F-25R	25 ft	150
17FV-12R	12.5 ft	150
17FV-25R	25 ft	150
17V-12R	12.5 ft	150
17V-25R	25 ft	150

(F) Flex Head models also available
(R) Rubber power cable assembly
(V) Some available with gas valves.



Flex-Head Model

24 Series • Air cooled

Description: Small head size for intricate work. Gas lens accessories available. Optional gas valve.

Part model	Cable assy.	Max Amps
24-12R	12.5 ft	80
24-25R	25 ft	80
24V-12R	12.5 ft	80
24V-25R	25 ft	80

(R) Rubber power cable assembly
(V) Some available with gas valves.

26 Series • Air cooled

Description: Maximum capacity air cooled. Ideal for field welding. Optional gas valve and flex heads. Gas lens accessories available. Rubber (R) or 2 pc. cables (-2).

Part model	Cable assy.	Max Amps	Part model	Cable assy.	Max Amps
26-12R	12.5 ft	200	26P-12R	12.5 ft	200
26-25R	25 ft	200	26P-25R	25 ft	200
26F-12R	12.5 ft	200	26V-12R	12.5 ft	200
26F-25R	25 ft	200	26V-25R	25 ft	200
26FV-12R	12.5 ft	200			
26FV-25R	25 ft	200			

(F) Flex Head models also available
(P) Pencil models also available
(R) Rubber power cable assembly
(V) Some available with gas valves.



The Symbol of the Independent Welding Distributor

TIG TORCH ASSEMBLY

9 9P 9V Parts Breakdown

125 AMPS • AIR COOLED

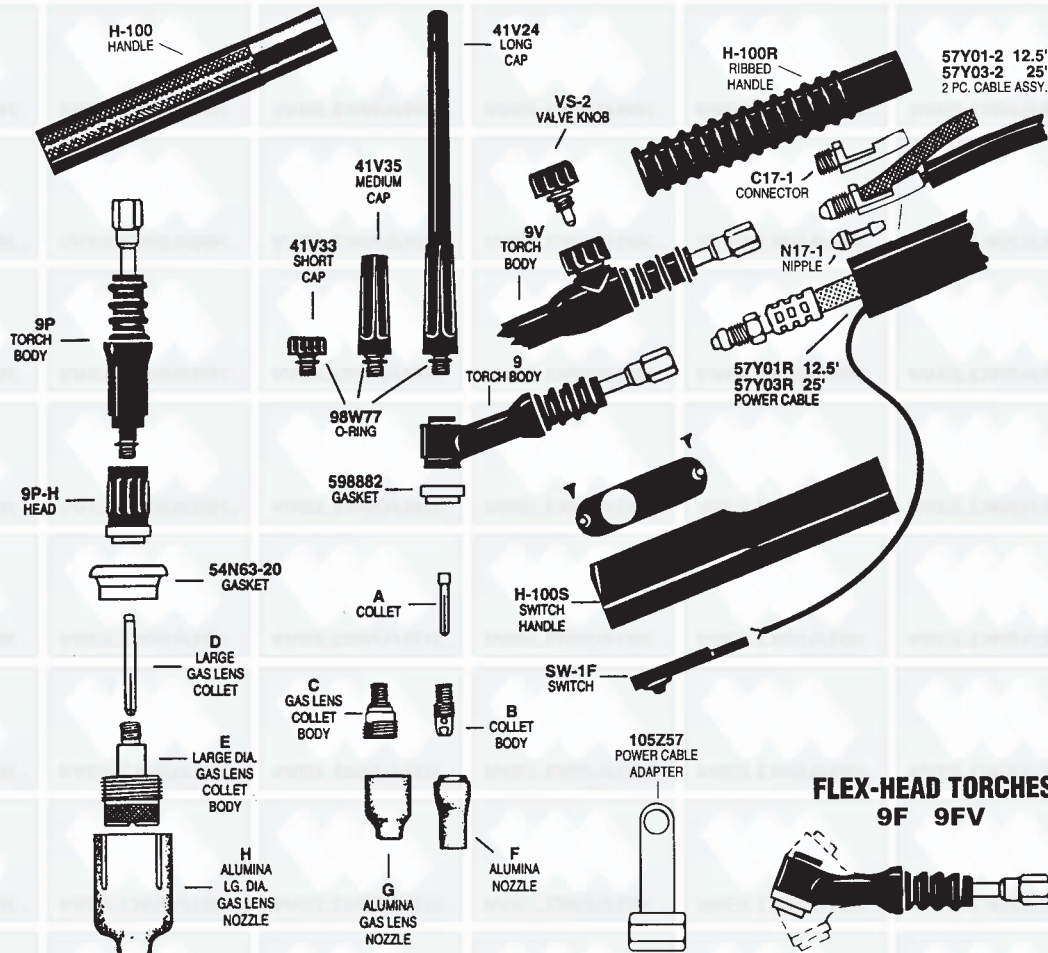

Collets • Collet Bodies • Gas Lens

Item	Electrode Diameter	.020 0, 5	.040 1, 0	1/16 1, 6	3/32 2, 4
A	Collet	13N20	13N21	13N22	13N23
B	Collet Body	13N25	13N26	13N27	13N28
C	Gas Lens	45V41	45V42	45V43	45V44
D	Lg. Dia. Gas Lens Collet	13N20L	13N21L	13N22L	13N23L
E	Lg. Dia. Gas Lens	45V0204S		45V116S	45V64S

Gas Nozzles

Item	Size	4 1/4"	5 5/16"	6 3/8"	7 7/16"	8 1/2"	10 5/8"	12 3/4"
F	Alumina	13N08	13N09	13N10	13N11	13N12	13N13	--
G	Alumina Gas Lens	53N58	53N59	53N60	53N61	53N61S	--	--
H	Alumina Lg. Dia. Gas Lens	--	--	57N75	--	57N74	53N88	53N87

Accessory Kit AK-1 9, 9V

Contains: Long cap, 3 Collets, 3 Collet Bodies, 3 Nozzles, 3 Tungsten Electrodes.



The Symbol of the Independent Welding Distributor

TIG TORCH ASSEMBLY

17 17V Parts Breakdown

150 AMPS • AIR COOLED

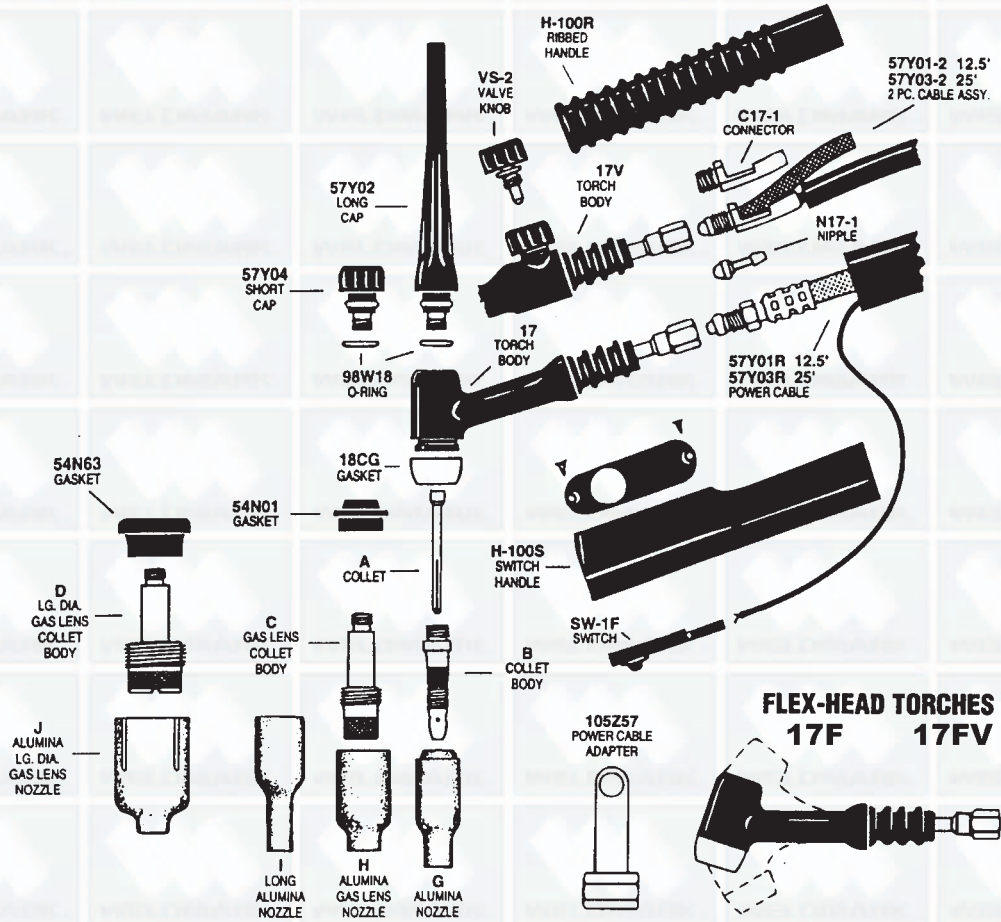

FLEX-HEAD TORCHES
17F 17FV

Collets • Collet Bodies • Gas Lens

Item	Electrode Diameter	.020 0, 5	.040 1, 0	1/16 1, 6	3/32 2, 4
A	Collet	10N21	10N22	10N23	10N24
B	Collet Body	10N29	10N30	10N31	10N32
C	Gas Lens	45V29	45V24	45V25	45V26
D	Lg. Dia. Gas Lens	45V0204		45V116	45V64

Gas Nozzles

Item	Size	4 1/4"	5 5/16"	6 3/8"	7 7/16"	8 1/2"	10 5/8"	12 3/4"	Short
G	Alumina	10N50	10N49	10N48	10N47	10N46	10N45	10N44	--
H	Alumina Gas Lens	54N18	54N17	54N16	54N15	54N14	--	--	54N19
I	Long Alumina	--	10N49L	10N48L	10N47L	--	--	--	--
J	Alumina Lg. Dia. Gas Lens	--	--	57N75	--	57N74	53N88	53N87	53N89

Accessory Kit AK-2 17, 17V

Contains: Short cap, 3 Collets, 3 Collet Bodies, 3 Nozzles, 3 Tungsten Electrodes.



The Symbol of the Independent Welding Distributor

TIG TORCH ASSEMBLY

26 26V Parts Breakdown

200 AMPS • AIR COOLED

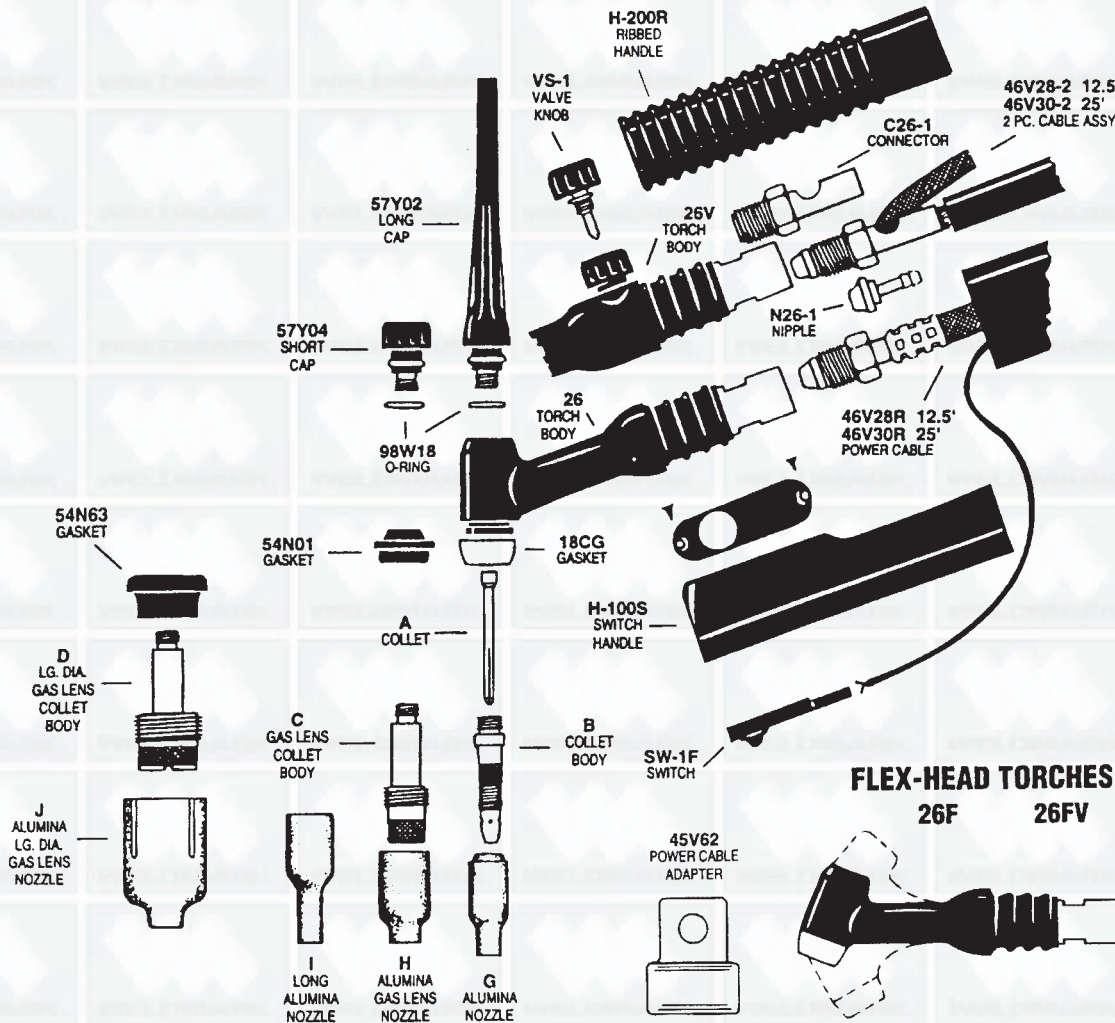

Collets • Collet Bodies • Gas Lens

Item	Electrode Diameter	.020 0, 5	.040 1, 0	1/16 1, 6	3/32 2, 4	1/8 3, 2
A	Collet	10N21	10N22	10N23	10N24	10N25
B	Collet Body	10N29	10N30	10N31	10N32	10N28
C	Gas Lens	45V29	45V24	45V25	45V26	45V27
D	Lg. Dia. Gas Lens	45V0204		45V116	45V64	995795

Gas Nozzles

Item	Size	4 1/4"	5 5/16"	6 3/8"	7 7/16"	8 1/2"	10 5/8"	12 3/4"	Short
G	Alumina	10N50	10N49	10N48	10N47	10N46	10N45	10N44	--
H	Alumina Gas Lens	54N18	54N17	54N16	54N15	54N14	--	--	54N19
I	Long Alumina	--	10N49L	10N48L	10N47L	--	--	--	--
J	Alumina Lg. Dia. Gas Lens	--	--	57N75	--	57N74	53N88	53N87	53N89

Accessory Kit AK-3 26, 26V

Contains: Short cap, 3 Collets, 3 Collet Bodies, 3 Nozzles, 3 Tungsten Electrodes.

Nylon & Leather Cable Covers

These zippered nylon cable covers hold and protect tig torch hoses and power cables together in a neat, flexible casing. The zipper on the nylon covers will not conduct high-frequency current and is protected from hot material contact by the overlap double-stitched construction. These protective covers will certainly pay for themselves by reducing hose and cable replacement costs. Also available are leather cable covers. Please see below.



Nylon Cable Covers

- 3-10 3" width
Nylon Cable Cover 10'
- 3-22 3" width
Nylon Cable Cover 22'
3" width bundles up to 3/4" diameter.
- 4-10 4" width
Nylon Cable Cover 22'
- 4-22 4" width
Nylon Cable Cover 22'
4" width bundles up to 1-1/4" diameter.



Leather Cable Covers

- WM893110
Leather Cable Cover 10' X 1-3/4"
 - WM893122
Leather Cable Cover 22' X 1-3/4"
- (Leather cable covers have metal snaps)

Accessory Kits • Hook-Up Kits • Extension Kits

Accessory Kits

These handy kits contain the most popular spare part items used with a particular torch model.



Kit Number	Torch Model	Kit Number	Torch Model
AK-1	9, 9V, 9F, 9FV	AK-4	20
AK-1A	9P	AK-4A	20P, 25
AK-2	17, 17V, 17E, 17FV	AK-5	24, 24V
AK-3	18, 18V	AK-5W	24W, 24WF
AK-3A	18SP		

Extension Kits

Need to extend the tig torch length? Then this is what you need. These kits contain supply hoses and power cable, couplers, and insulator required to get the job done.



Kit Number	Torch Model
EK-1-25	Water Cooled (18, 20)
EK-2-25-R	Air Cooled (9, 17)

Hook-Up Kits

Everything needed to connect the tig torch to the welding machine, water cooling source and gas supply regulator/flowmeter: supply hoses, fittings and power cable adapter (water cooled torches only).



Kit Number	Torch Model
HK-1	Water Cooled (18, 20, 25)
HK-2	Air Cooled Valve (9V, 17V)
HK-3	Air Cooled (9, 17)

**Call your IWDC distributor
for a recommendation
on the proper Tig Torch
for your application.**



The Symbol of the Independent Welding Distributor

TUNGSTEN ELECTRODES



Tungsten Electrodes Line

Most commonly Used

Pure

- Part #: WM417040
.040" x 7" Ground
- Part #: WM417116
1/16" x 7" Ground
- Part #: WM417332
3/32" x 7" Ground
- Part #: WM41718
1/8" x 7" Ground
- Part #: WM417532
5/32" x 7" Ground

2% Thoriated

- Part #: WM437040
.040" x 7" Ground
- Part #: WM437116
1/16" x 7" Ground
- Part #: WM437332
3/32" x 7" Ground
- Part #: WM43718
1/8" x 7" Ground
- Part #: WM437532
5/32" x 7" Ground

1.5% Lanthanated

- Part #: WM457040
.040" x 7" Ground
- Part #: WM457116
1/16" x 7" Ground
- Part #: WM457332
3/32" x 7" Ground
- Part #: WM45718
1/8" x 7" Ground
- Part #: WM457532
5/32" x 7" Ground

Characteristics

Pure Tungsten (EWP)

Color code:Green

These electrodes are primary used with alternating current (AC) for welding of aluminum and magnesium alloys. With this type of current, the tip of the EWP electrode forms a clean, balled end, which provides good arc stability. Pure tungsten is the least expensive, but it is more prone to contamination of the weld than the other types of tungsten electrodes.

Thoriated Tungsten (EWTh-2)

Color code:2% Red

Thoriated tungsten electrodes were designed for direct current electrode negative (DCEN) or straight polarity applications. They maintain a sharpened tip configuration during welding which is desirable for the welding of steels, nickel alloys and most alloys other than aluminum and magnesium. Thoriated tungsten electrodes are not normally used with AC welding because it is difficult to maintain the balled end (which is necessary with AC welding) without splitting the electrode.

Lanthanated EWL-1.5)

Color code:Gold

These electrodes can be used as a nonradioactive substitute for 2% thoriated tungsten. They will provide very similar performance with minimum amount of adjustment or operating conditions required. These materials are certified to be free of radioactivity.

See back for other available types.

AWS Classification

Weldmark® tungsten electrodes are manufactured to the high level of quality defined by the American Welding Society. ANSI/AWS Specifications (A5.12)

AWS Class	Color Code	Min.Wt.% Tungsten	Type	Wt.%	Wt. % other Elements
EWP	Green	99.5	(pure W)	--	0.5
EWTh-1	Yellow	98.3	thoria	0.8-1.2	0.5
EWTh-2	Red	97.3	thoria	1.7-2.2	0.5
EWZr-1	Brown	99.1	zirconia	0.15-0.4	0.5
EWCe-2	Orange	97.3	ceria	1.8-2.2	0.5
EWL-1.5	Gold	97.8	lanthana	1.3-1.7	0.5

Other Tungstens Available

Zirconiated Tungsten (EWZr-1)

Color code: Brown

These electrodes have characteristics that fall between pure and thoriated electrodes. They are normally the electrode of choice for AC welding of aluminum and magnesium alloys because they combine the desirable arc stability characteristics and balled end typical of pure tungsten along with the higher current capacity and better arc starting characteristics of thoriated tungsten electrodes.

Ceriated Tungsten (EWCe-2)

Color code: Orange

These electrodes are characterized by ease of starting, good arc stability, long life, high current capacity and lack of radioactivity. Ceriated electrodes will operate successfully with AC or DC.

Standard Sizes and Lengths

Standard Sizes, inches		Tolerance on Actual Size, Inches	* Standard Length, inches
Nominal Size	Actual Size		
0.010	0.010	0.001	7
0.020	0.020	0.002	7
0.040	0.040	0.003	7
1/16	0.062	0.003	7
3/32	0.093	0.003	7
1/8	0.125	0.003	7
5/32	0.156	0.003	7
3/16	0.187	0.003	7
1/4	0.250	0.003	7

* Note: Other types and sizes of tungstens are also available. Call your local Weldmark® distributor for pricing availability.

The Gas Tungsten Arc Welding Process (GTAW)

GTA welding, developed in the 1940's, uses the intense, localized heat of an electric arc. This process, also known as TIG, makes use of an inert shielding gas to protect both the hot workpiece and a nonconsumable tungsten electrode while the fusion operation is takes place. GTAW is capable of providing welds of exceptional quality and cleanliness and is therefore the method of choice for many high precision, high reliability assemblies.

ANSI AWS A5.12 Classification System

Tungsten electrodes are classified on the basis of their chemical compositions.

E: stands for an electrode

W: stands for the chemical symbol for tungsten

The final lettering indicates the alloying element or oxide additions.

P: Pure

Zr: Zirconiated

Th: Thoriated

Ce: Ceriated

La: Lanthanated

The numbers specify the nominal alloying composition (in weight - percent).

For instance, EWTH-2 is a thoriated tungsten electrode that contains nominally 2 wt - % thoria.

Typical Selection of Gases for Gas Tungsten Arc Welding (GTAW)

Metal	Type of Welding Process	Shielding Gas	Advantages
Aluminum and its Alloys	Manual continuous	Argon	Better arc starting and cleaning action; lower gas consumption.
	Manual continuous	Helium	High welding speeds possible. (use with DC polarity).
	Machine continuous	Argon-Helium	Lower gas flow than required with straight helium.
Magnesium and its Alloys	Less than 1/4 in.	Argon	Controlled penetration; excellent cleaning; ease of puddle manipulation; low gas flow.
	Greater than 1/4 in.	Helium	Good penetration; best for DC welding.
Carbon Steel	Manual continuous	Argon	Ease of manipulation; freedom from overheating; better puddle control, especially for position welding.
	Machine continuous	Argon-Helium	Helium addition improves penetration on heavy gauge metal; preference depends on joint preparation.
	Spot	Argon	Generally preferred for longer electrode life, better weld nugget contour, ease of starting, lower gas flow.
Austenitic Chromium-Nickel Stainless Steel	Manual continuous	Argon	Permits controlled penetration on thin-gauge material (up to 15 gauge).
	Manual continuous	Argon-Helium	Higher heat input and welding speeds possible on heavier gauges.
	Machine continuous	Argon-Hydrogen (35% H ₂ max)	Prevents undercutting; produces desirable weld contour at low current levels; requires lower gas flows.
	Machine continuous	Helium	Provides highest heat input and deepest penetration.
Copper, Nickel and their Alloys		Argon	Ease of obtaining puddle control, penetration and bead contour on thin-gauge metal.
		Argon-Helium	Higher heat input to offset high conductivity of heavier gauges.
		Helium	Highest heat input for high welding speed on heavy metal section.
Titanium and its Alloys		Argon	Low gas flow rate minimizes turbulence and air contamination of weld.
		Helium	Better penetration for welding of thick sections (inert-gas backing required to shield back of weld against contamination).

Call your local Weldmark® distributor for the proper selection of shielding gas for your gas tungsten arc welding process (GTAW).





WATER RECIRCULATOR

Tig Torch Cooling System



Part#	Description	Std Pk
WEM TIGER-115	Water Recirculator, 2 Gal 115 VAC Bench Type (230 VAC model also available - Special order)	1

- Plastic Water tank eliminates coolant contamination due to electrolysis or chemical reactions.
- All units are plumbed with copper tubing and reinforced hose.
- New extended life pump features a direct drive power system reducing maintenance and vibration.
- No external plumbing is required because of closed loop water system.
- Self Priming Pump
- Easy Change Pump
- Strong rigid construction designed to support power unit.
- Compact Design

Specifications

- Factory set at 50 psi
- 2 gallon reservoir
- 115 vac / single phase- 50/60 hz (230 vac also available)
- 3.2/ 1.5 amp: 60 hz
- 10,000 BTU
- Dimensions: 12”L x 14”W x 9”H
- 1/4” Female Pipe Fitting (water in/out) with 5/8 LH Std. Inert Gas Fitting
- 8 foot power cord
- Visible water level through tank
- Thermal overload
- Net weight: 30 lbs. / 13.6 kg
- Foam packed for UPS shipment

Tech Sheet & Parts List/Diagram included with unit.

The TIG-er Cooling System is designed for TIG & MIG torches up to 250 amps.

DYNAFLUX WATER RECIRCULATORS

TIG TORCH COOLING SYSTEM

SPECIFICATIONS:

- Factory set at 50 psi
- 2 gallon reservoir
- 115 or 230vac / single phase- 50/60 hz
- 3.2 / 1.5 amp : 60 Hz
- 10,000 BTU
- Dimensions: 12"L x 14W x 9"H
- Net weight: 30 lbs / 13.6 kg
- Foam packed for UPS shipment
- 0.8 gpm @ 50 psi



The **TIG-er Cooling System** is designed for:
 TIG torches 250 amps
 MIG guns 250 amps



The **ProCool II V/G Cooling System** is designed for:
 MIG guns 500amps
 TIG torches 500amps
 RESISTANCE Welders: 60 KVA
 12,000 BTU/HR @ 75 Degrees Differential

PROCOOL II V/G COOLING SYSTEM

SPECIFICATIONS:

- Factory set at 50 psi adjustable to 80 psi
- 3 gallon reservoir
- 115 or 230vac / single phase- 50/60 hz
- 5.6 / 2.8 amp : 60 Hz
- 12,000 BTU
- Dimensions: 18"L x 14"W x 9"H
- Net weight: 37 lbs / 17 kg
- Foam packed for UPS shipment

PCII: Rotary GEAR Pump

- 1.8 gpm at 50 psi
- Built in by-pass to tank
- Rebuildable Pump (Repair Kit No. P3001)

PCIV: Rotary VANE Pump

- 1.7 pgm at 50 psi

R1100 V/G COOLING SYSTEM

SPECIFICATIONS:

- Factory set at 50 psi adjustable to 100 psi
- 3 gallon reservoir
- 115 or 230vac / single phase- 50/60 hz
- 15,000 BTU
- Dimensions: 23"L x 11"W x 14.75"H
- Net weight: 42 lbs / 19 kg
- Foam packed for UPS shipment

R1100G: Rotary GEAR Pump

- 1.8 gpm at 50 psi
- Built in by-pass to tank
- Rebuildable Pump (Repair Kit No. P3001)

R1100V Rotary VANE Pump

- 1.7 pgm at 50 psi



The **R1100 V/G Cooling System** is designed for:
 MIG guns 750 amps
 TIG torches 750 amps
 PLASMA Welders/Cutters 200 amps
 RESISTANCE Welders: 75 KVA
 INDUCTION Welding : 5 KW
 15,000 BTU/HR @ 75 Degrees Differential

Made in U.S.A.